

WHITE CAVE HOUSE BY TAKURO YAMAMOTO ARCHITECTS

Set in snowy Kanazawa City in Japan, this unique home has been designed to pay homage to its landscape. The minimal home has many external spaces including a large snow-proof entrance, a roofed garage for multiple cars, a terrace facing the sky and a courtyard. Each area is connected to the other via a single 'tube' - the cave - creating privacy while letting in the sun. The natural elements are very much a part of this home: as the light changes throughout the day, so does the view of the building, while a thin layer of water on the terrace reflects the sky, transporting you instantly from your daily life.

takuroyama.jp



TOMORROW HOUSE

From energy neutral homes to copper-clad residential icons, the new ARCHITECTURE is all about sense and structure

IMAGE COURTESY OF TAKURO YAMAMOTO ARCHITECTS

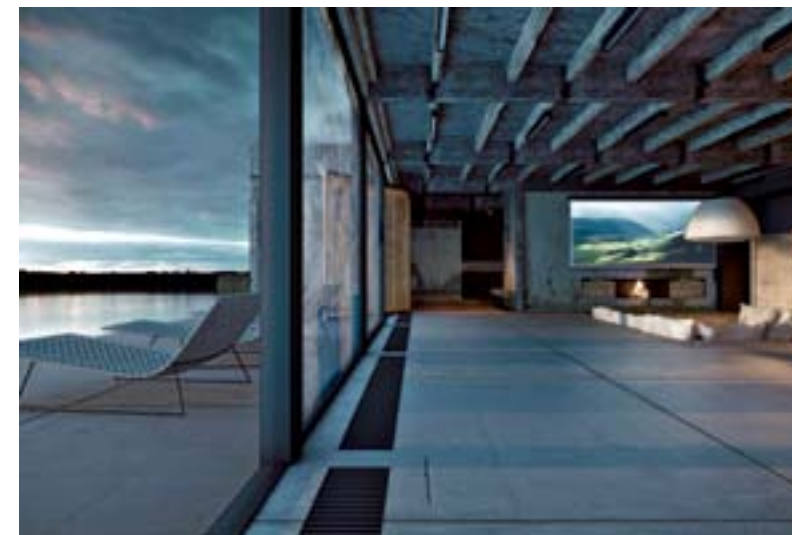
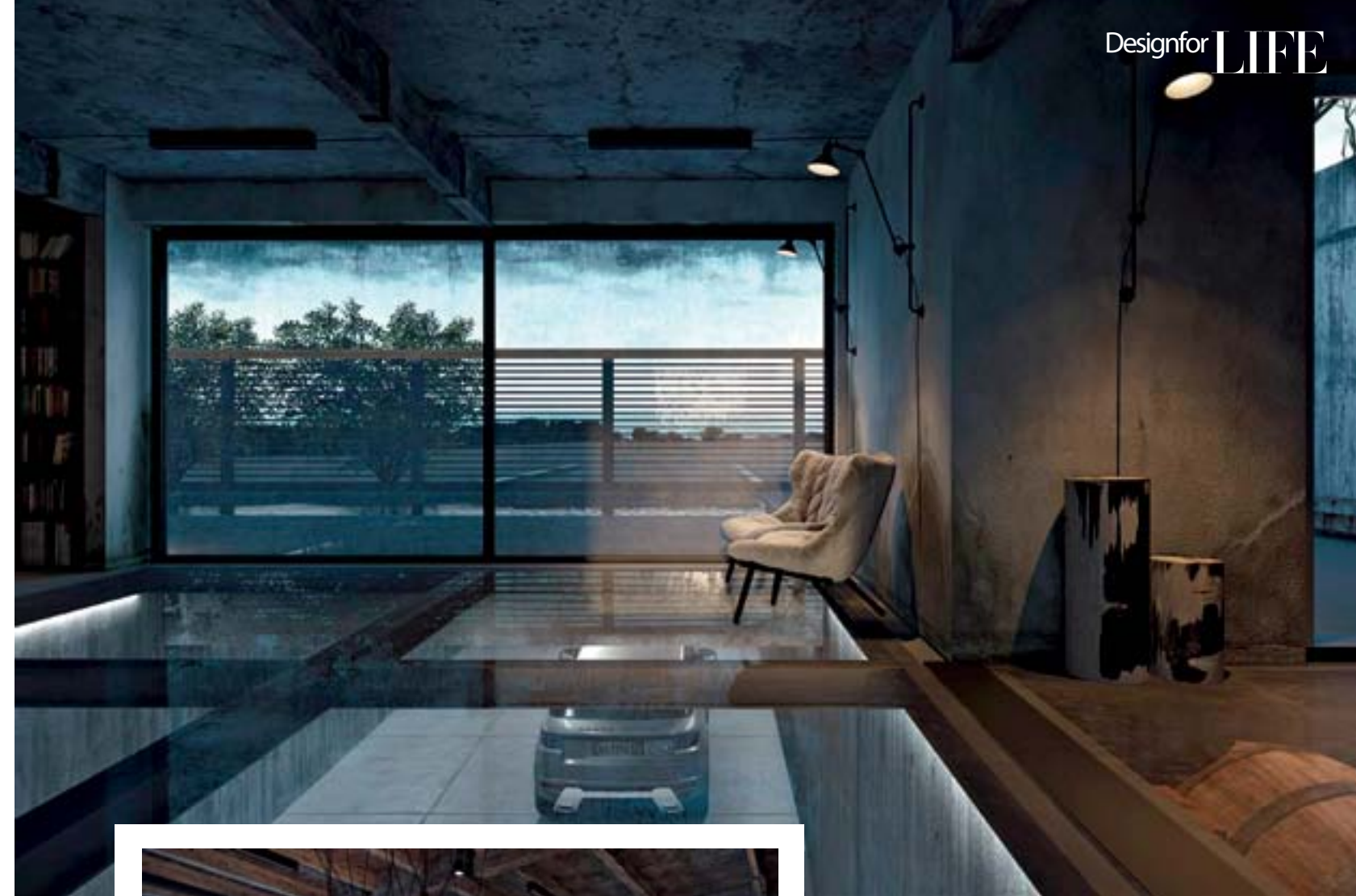

IMAGE COURTESY OF IGOR SIROTOV

DA HOUSE BY IGOR SIROTOV *On a vast plane skirting the dramatic Black Sea coast in Bulgaria, this house has been designed to harmonise with its environment, while in every room celebrating the spectacular views. Inspired by Japanese architecture, the stark concrete structure is balanced by glass and a tree to bring cosiness and heat. Light from the picture windows works hand in hand with artificial light to create dramatic spaces across the single floor, through which the car port is visible - a quiet space that has a pacifying influence on the living experience.*
igorsirotov.com

18.36.54 HOUSE BY DANIEL LIBESKIND

This spectacular 2000sqf Connecticut home designed by one of the hottest names in contemporary architecture, dominates its rural setting. The living space of this family residence is formed by a spiraling ribbon of 18 copper planes that reflect the environment, the metal changing colour as day moves to night. The continuous ribbon structure unfolds to define the roofs, walls and floors, creating distinctive interior spaces while framing the landscape beautifully. daniel-libeskind.com



PHOTOGRAPHY BY NIKOLAS KOENIG

VILLA KOGELHOF BY PAUL DE RUITER *This award-winning house is energy neutral. Employing the latest technology it is climate controlled all year round while being totally energy efficient. The building itself, striking and abstract, is two stacks, one underground, the other floating above it - in an uncompromising glass box supported by a steel frame. The climate-facade exterior is eco-smart. The clear insulated glass, covered with sun reflecting fabric, can be rolled up or down depending on the weather. Meanwhile electricity is provided by PV-cells on the roof and soon, a wind turbine.*



PHOTOGRAPHY BY JEROEN MUSCH

One of the main principles of the villa was to translate luxury into "happy independence." The goal was to make the home self-sufficient in every sense; to generate its own energy, to heat its own water and to recycle garbage. Aside from its practical and ecological benefits, the home is an impressive contribution to the landscape, providing a contrast with the barren nature of the Dutch coastline paulderuiter.nl





HOUSE BETWEEN TWO GARDENS BY PITSOU KEDEM ARCHITECTS
This imposing private residence hovers between two courtyards, allowing natural light to flood into the interior spaces. The brilliant white cube has double height glass doors that at the touch of a button open up an entire facade of the house connecting the inside with the lush garden, bathing the open-plan living, dining and kitchen areas in light from both the east and west. From the back garden, the strip infinity pool appears to recede into the home while from the street the house is barely visible. pitsou.com



PHOTOGRAPHY BY AMIT GERON

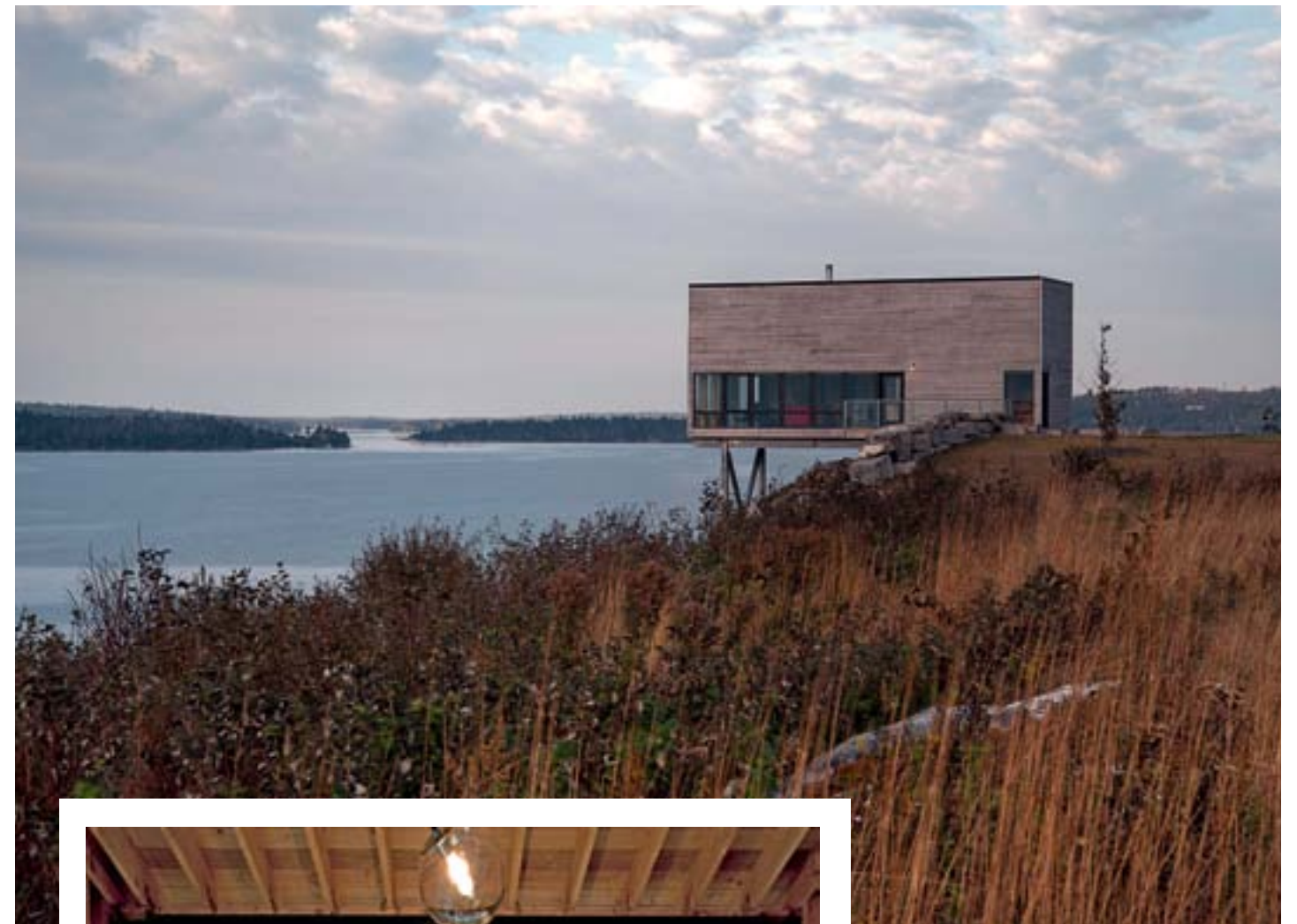

IMAGES COURTESY OF MACKAY-LYONS SWEETAPPLE ARCHITECTS

CLIFF HOUSE BY MACKAY-LYONS SWEETAPPLE ARCHITECTS

This project is the first of a series of projects for a large 455-acre site on Nova Scotia's Atlantic coast. This pure box in the landscape is precariously perched off a bedrock cliff as if it's floating on the seas. The effect is vertiginous, heightening our experience of the landscape.
 The large galvanized steel superstructure anchors it to the cliff, while the skeleton itself is made from light steel, clad in cedar shiplap. Believe it or not, this is affordable luxury, built with the express intention of being a second home. It's a prototype that can be repeated as desired.
 Not being an everyday home, the rustic 960sqm retreat justifies its comparatively diminutive proportions. The main level contains a great room and in the open loft a cosy sleeping perch for windy nights. Such a dramatic setting wouldn't be complete without a large south-facing deck to absorb the first rays of the sun and extend the living space out through the large windows.
mlsarchitects.ca